



Lowcountry Society of
Women Engineers

December News

MEETING

DEC 5TH, 2011

5:30PM—7:00PM

@ HYATT PLACE NORTH CHARLESTON

(7331 MAZYCK ROAD, NORTH CHARLESTON - BEHIND THE CRACKER BARREL ON ASHLEY PHOSPHATE)

COST: \$10.00 MEMBERS AND \$15.00 NON-MEMBERS

"What Makes Solar Work in South Carolina...Or Anywhere Else for That Matter"

**5:30-6:15PM NETWORKING AND DINNER
6:15-7:00PM FEATURED PRESENTATION BY
ANTHONY DEL PORTO**

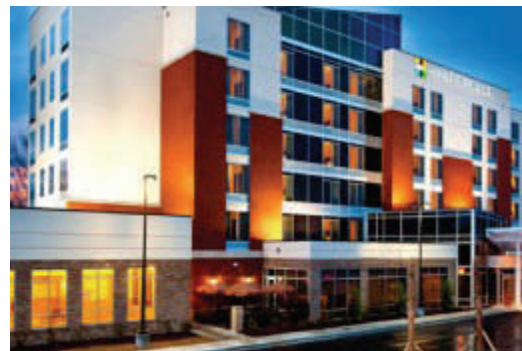

PLEASE RSVP TO RSVP@SWELOWCOUNTRY.ORG

Join us to learn what drives the solar industry, methods for making the finances work, and the state of the technology (both Photovoltaic and Solar Hot Water)

SWE Lowcountry needs volunteers

Calling all women! SWE Lowcountry has several different roles and we need members to fill them. There are several open positions on the board that presently need to be filled. We also have opportunities for volunteers to be involved with the regional conference. Help shape our section



Imprint on our local area. We are looking forward to an exciting 2012 and hope that you will be part of it. If you are interested, please contact

Lauren Wolf at

president@swelowcountry.org to see how you can get involved with our SWE Section!



Summerville High students want plant tours

Summerville high school is looking to improve the engineering program based on student feedback. One item that students feel is lacking is the “real-world” application of what they are learning in their courses. The school is looking for volunteers to set-up plant tours for students.

Groups of 1 to 4 students would like to tour area facilities and learn about the different career paths within engineering. Students are interested in a variety of fields, so any tours that are possible would be appreciated. If a plant tour is not feasible due to restrictions, but you could present on the fields of engineering within the

facility, students would still like to learn. If you would like to assist with this endeavor, please contact Ms. Melvin directly at mmelvin@dorchester2.k12.sc.us. Thank you in advance for volun-

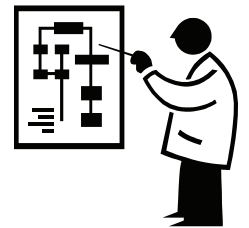

Girl Scout Event to celebrate Engineers' Week

“Tell me and I’ll forget; show me and I may remember; involve me and I’ll understand.”

~ Chinese Proverb

To celebrate Engineers’ Week SWE Lowcountry is teaming up with the Citadel SWE section to host a girl scout event to celebrate engineers’ week and inspire some young women to consider engineering for a ca-

reer path. The event will be on February 19th. Girl scouts will have the opportunity to participate in a few workshops that will teach them some basic engineering principles. The girls will then be able to take their pro-

ject home with them. Be on the lookout, a call for volunteers will be sent out in the next few weeks, so please mark the date on your calendar. We hope to see you there!

Ideas wanted for future events!

The SWE Board is planning the 2012 calendar to be fun-filled and awesome!

We would like to hear from you what types of events you would like: Social, Professional, events you can bring the kids to, what would YOU like to see? Feel free to let us know of any ideas that you may have. We’re up for planning anything from another brewery event to wine tastings to



workshops on effective communications, perhaps a fashion show for work clothes! Who knows what we can come up with!

Please e-mail Lauren Wolf at president@swelowcountry.org. Also, as we plan our events, make sure you check our website, mark your calendar, and bring a friend! The more, the merrier! We are really looking forward to enjoying 2012!

Oktoberfest at Westbrook Brewing

SWE

Lowcountry had the opportunity in October to tour Westbrook Brewing. It was a great experience to share Edward and Morgan Westbrook's excitement for brewing and to see their creative spirit come through their beer. We learned about their beginnings to brewing and got to learn what a passion for brewing they have.

Among the different beers that we were able to sample, there was a beer that was made with lemongrass and ginger! Who would have thought that combination worked?

Morgan toured us around the brewery and we learned all about the process to make beer, and even learned how barrels can be used to make beer.



It was also very interesting to see the beginning of a canning process as they had just got their canning machine and had canned the first several six packs!

If you missed out on the tour, look for a six-pack of their beers at Whole Foods, Piggly Wiggly, and a few other local grocery stores.

The best part was that their recycled malt goes to local farmers for pig feed. Talk about environmentally friendly!

We hope to make it back out for a spring tasting since they are constantly changing their flavors!

If you didn't get a chance to come out for the tour, but would like more information, feel free to look up "Westbrook Brewing" on facebook for more information!

Happy Holidays!



*Do you have something
for next month's
newsletter?*

*Maybe a success story, or an article
that you wanted to share with others?
Send Priya an e-mail*

*(secretary@swelocountry.org) with topics,
and/or suggestions by the*

*10th of every month and the goal is to
have them distributed by the 15th of
every month!*